

4-gas Detector

H₂S
CO
O₂
LEL

GasAlert MicroClip XT



Multi-gas made simple

The slim and compact GasAlertMicroClip XT provides affordable protection from atmospheric hazards. This multi-gas detector offers continuous visual confirmation of detector operation and compliance with the IntelliFlash™ feature and simple one-button operation offers ultimate ease of use and significantly reduces time spent training the user. The GasAlertMicroClip XT is fully compatible with BW's MicroDock II automatic test and calibration system.

Standard Package Contents

- Detector complete with specified sensor(s), stainless steel alligator clip and concussion-proof housing
- Rechargeable lithium polymer battery
- Charging adaptor
- Calibration/test cap and hose
- Manual
- Multi-language CD manual

General Specifications

Size	4.4 x 2.4 x 1.1 in. / 11.3 x 6.0 x 2.9 cm
Weight	6 oz. / 171 g
Temperature	-4 to +122°F / -20 to +50°C
Typical battery life	10 hours (typical); recharges in less than four hours
Certifications and approvals	CE: Class I, Div. 1, Gr. A, B, C, D ATEX: CE II 1 G Ga Ex ia IIC T4 IECEx: Ga Ex ia IIC T4 CE: European Conformity
Warranty	Full two year warranty including all sensors

IntelliFlash

**WATER
RESISTANT** 

6642-1

GasAlertMicroClip XT 4-Gas Detector	Order Number	
	Yellow	Black
%LEL, O ₂ , H ₂ S, CO	MC2-XWHM-Y-NA	MC2-XWHM-B-NA

GasAlertMicroClip XT 3-Gas Detector	Order Number	
	Yellow	Black
%LEL, O ₂ , H ₂ S	MC2-XWH0-Y-NA	MC2-XWH0-B-NA
%LEL, O ₂ , CO	MC2-XW0M-Y-NA	MC2-XW0M-B-NA
%LEL, H ₂ S, CO	MC2-0WHM-Y-NA	MC2-0WHM-B-NA
O ₂ , H ₂ S, CO	MC2-X0HM-Y-NA	MC2-X0HM-B-NA

GasAlertMicroClip XT 2-Gas Detector	Order Number	
	Yellow	Black
%LEL, O ₂	MC2-XW00-Y-NA	MC2-XW00-B-NA
%LEL, H ₂ S	MC2-0WH0-Y-NA	MC2-0WH0-B-NA
%LEL, CO	MC2-0W0M-Y-NA	MC2-0W0M-B-NA
H ₂ S, CO	MC2-00HM-Y-NA	MC2-00HM-B-NA
O ₂ , H ₂ S	MC2-X0H0-Y-NA	MC2-X0H0-B-NA
O ₂ , CO	MC2-X00M-Y-NA	MC2-X00M-B-NA

GasAlertMicroClip XT 1-Gas Detector	Order Number	
	Yellow	Black
%LEL	MC2-0W00-Y-NA	MC2-0W00-B-NA
O ₂	MC2-X000-Y-NA	MC2-X000-B-NA
H ₂ S	MC2-00H0-Y-NA	MC2-00H0-B-NA
CO	MC2-000M-Y-NA	MC2-000M-B-NA

GasAlertMicroClip XT Region Codes

For orders outside North America, change order number component “-NA” to:

“-EU”	Europe	“-BR”	Brazil
“-UK”	United Kingdom	“-OR”	Other region with 3-pin UK plug
“-AU”	Australia	“-OE”	Other region with 2-pin UK plug
“-CN”	China/New Zealand		

Gas Legend

%LEL	Combustible
O ₂	Oxygen
H ₂ S	Hydrogen sulfide
CO	Carbon monoxide



MicroDock II
Automatic test and calibration station (see MicroDock II section for additional information)

GasAlertMicroClip XT

4 - GAS DETECTOR

Confined Space Kit

GasAlertMicroClip XT deluxe confined space kit – includes manual aspirator kit, IR connectivity kit, calibration cap with 1 ft. / 0.3 m hose, 0.5 LPM regulator, sampling probe, leather carrying case and auxiliary filter

Detector, calibration gas and motorized sampling pump sold separately.

Carrying case for GasAlertMicroClip XT with foam and lid insert

Order Number

MC-CK-DL

MC-CK-CC

Carrying Accessories

Neck strap with safety release

Short strap (6 in. / 15.2 cm)

Extension strap (4 ft. / 1.2 m)

Chest harness

Black leather and PVC carrying holster

Carrying case for motorized sampling pump and/or the detector

Order Number

GA-NS-1

GA-LY-1

GA-ES-1

GA-CH-2

MC2-LC-1

SPAK-CC1

Power Options and Spares

Multi-unit (5) cradle charger

Multi-unit (5) power adaptor

12-24 Vdc vehicle power adaptor

12-24 Vdc direct-wire power adaptor

Replacement power adaptor

Order Number

MC2-C01-MC5

GA-PA-1-MC5-NA*

GA-VPA-1

GA-PA-3

GA-PA-1-NA*

**For regions outside North America replace “-NA” with: “-EU” for Europe, “-UK” for United Kingdom and “-AU” for Australia/China.*



Black Leather PVC case
MC2-LC-1

Deluxe Confined Space Kit

MC-CK-DL

Order detector, calibration gas and motorized sampling pump separately.



Multi-Unit Power Adaptor

GA-PA-1-MC5-NA*

Simultaneously charges five detectors



Vehicle Power Adaptor

12-24 Vdc

GA-VPA-1



Multi-Unit Cradle Charger

MC2-C01-MC5

Simultaneously charges five detectors



Direct-Wire Power Adaptor

12-24 Vdc

GA-PA-3

Datalogging Accessories

IR connectivity kit with Fleet Manager II software

Order Number

GA-USB1-IR

Sampling/Testing Equipment and Spares

Test cap and hose (1 ft. / 0.3 m) replacement

MC-TC-1

MicroDock II

- Base station and **GasAlertMicroClip XT** docking module with charging cable
- Base station and **GasAlertMicroClip XT** docking module without charging cable
- **GasAlertMicroClip XT** docking module with charging cable
- **GasAlertMicroClip XT** docking module without charging cable

DOCK2-2-1C1P-00-G
DOCK2-2-1P-00-G
DOCK2-0-1C1P-00-G
DOCK2-0-1P-00-G

Note: For earlier models of GasAlertMicroClip and for complete MicroDock II system configuration information, see MicroDock II section.

Auxiliary filter kit (complete with filter adaptor and 5 filters)

MC-AF-K1

Auxiliary filter adaptor (no filters)

MC-AF-1

Auxiliary filter replacement for adaptor, kit of 10

MC-SS-AF-K1

SamplerPak motorized sampling pump kit

GA-SPAK

For a complete list of SamplerPak probes, hoses, accessories and spares, see SamplerPak section.

Manual aspirator pump kit with probe (1 ft. / 0.3 m)

MC-AS01

Sensor Spares

Order Number

Replacement MICROpeL® combustible (LEL) sensor

SR-W-MP75C

Replacement Oxygen (O₂) sensor *(for use with GasAlertMicroClip XT models "MC2-")*

SR-X10-C1

Replacement MICROceL® oxygen (O₂) sensor *(for use with legacy GasAlertMicroClip models "MC-")*

SR-X-MC

Replacement MICROceL® hydrogen sulfide (H₂S) sensor

SR-H-MC

Replacement MICROceL® carbon monoxide (CO) sensor

SR-M-MC

Dummy sensor for combustible (LEL) sensor location

SR-W-MC-DUM

Dummy sensor for oxygen (O₂) sensor location *(for use with GasAlertMicroClip XT models "MC2-")*

SR-DUMM1

Dummy sensor for oxygen (O₂) sensor location *(for use with legacy GasAlertMicroClip models "MC-")*

SR-X-MC-DUM

Dummy sensor for toxic sensor locations

SR-TOX-MC-DUM

Replacement quad sensor screens, kit of 2 for GasAlertMicroClip XT (models "MC2-")

MC2-SS

Replacement quad sensor screens, kit of 10 for GasAlertMicroClip XT (models "MC2-")

MC2-SS-K1

Replacement quad sensor screens, kit of 2 for legacy GasAlertMicroClip (models "MC-")

MC-SS

Replacement quad sensor screens, kit of 10 for legacy GasAlertMicroClip (models "MC-")

MC-SS-K1



IR Connectivity Kit

GA-USB1-IR

Use for data download and instrument set-up options; includes software



Auxiliary Filter Kit

MC-AF-K1

Easily attaches in the field to protect the internal filter



Manual Aspirator Pump Kit

MC-AS01

For remote sampling; complete with probe, hose, aspirator pump and adaptor cap



Test Cap
MC-TC-1



SamplerPak Kits

Kits include motorized sampling pump, batteries and battery charger (if specified). See SamplerPak section for kit contents, accessories and spares; detector sold separately.

4 - GAS DETECTOR

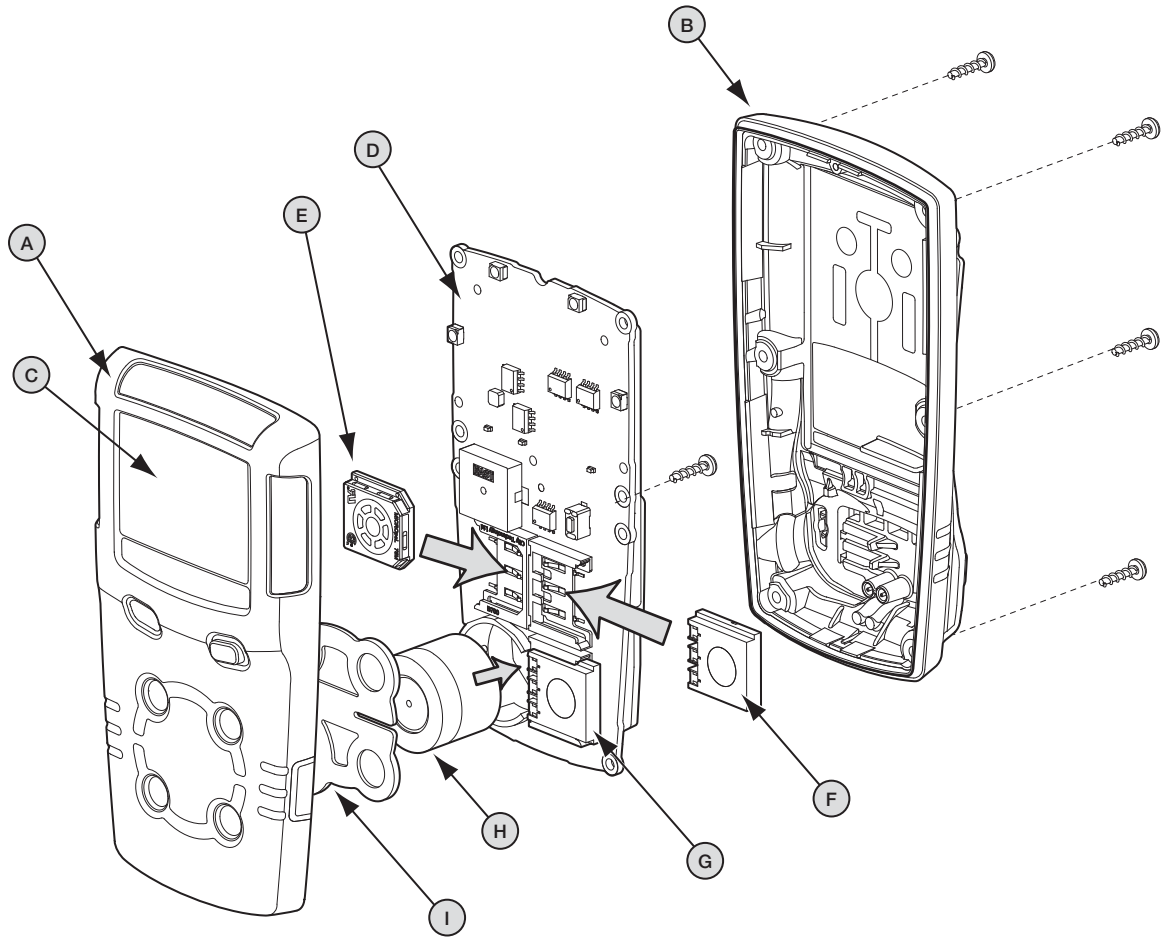

Note: Please refer to the instrument's documentation (shipped with the product or available at www.gasmonitors.com) for complete instructions on common service procedures. Improper servicing or maintenance may affect warranty eligibility. BW assumes no liability for damages resulting from improper servicing or maintenance.

Service Parts	Order Number	Legend
Replacement front enclosure (yellow) for GasAlertMicroClip XT	MC2-FC1	A
Replacement front enclosure (black) for GasAlertMicroClip XT	MC2-FC1B	
Replacement back enclosure (yellow) for GasAlertMicroClip XT	MC2-BC1	B
Replacement back enclosure (black) for GasAlertMicroClip XT	MC2-BC1B	
Replacement flex PCB for GasAlertMicroClip XT	MC2-FPCB1	
Replacement main PCB with battery and screw for GasAlertMicroClip XT	MC2-MPCB1	D
Replacement LCD kit for GasAlertMicroClip XT <i>Note: Also compatible with legacy GasAlertMicroClip models</i>	MC-LCD-K1	C

How to Replace a Sensor

1. With monitor OFF, use No. 1 Phillips screwdriver to remove 6 screws from back enclosure (B)
2. Lift back enclosure (B) straight up
3. Use No. 1 Phillips screwdriver to remove 2 screws from back of PCB (D)
4. Lift PCB (D) together with battery and sensors (E-H) straight up
5. Remove sensor (E-G) by sliding out or sensor (H) by pulling straight up from PCB (D)
6. Insert new sensor (E-H) into PCB (D)
7. Replace PCB (D) and 2 screws and hand-tighten until firm
8. Replace back enclosure (B)
9. Replace 6 screws in back enclosure (B) and hand-tighten until firm

How to Replace the Sensor Screen

1. With monitor OFF, use No. 1 Phillips screwdriver to remove 6 screws from back enclosure (B)
2. Lift back enclosure (B) straight up
3. Use No. 1 Phillips screwdriver to remove 2 screws from back of PCB (D)
4. Lift PCB (D) together with battery and sensors (E-H) straight up
5. Remove sensor screen (I) from front enclosure (A)
6. Insert new sensor screen (I) into front enclosure (A)
7. Replace PCB (D) and 2 screws and hand-tighten until firm
8. Replace back enclosure (B)
9. Replace 6 screws in back enclosure (B) and hand-tighten until firm

Note: Please refer to the instrument's documentation (shipped with the product or available at www.gasmonitors.com) for complete instructions on common service procedures. Improper servicing or maintenance may affect warranty eligibility. BW assumes no liability for damages resulting from improper servicing or maintenance.